



**AVANT GUARD**

# **D30**

**WIFI SMART DOOR LOCK**

**User Manual**

# Contents

1. Warning and Safety Instructions .....	4
2. Product Layout .....	5
3. Components .....	6
3.1. Accessories List .....	6
4. Installations .....	7
5. Lock Functions .....	9
5.1. Unlocking Methods .....	9
5.1.1. Fingerprint .....	9
5.1.2. Password .....	9
5.1.3. Card .....	10
5.1.4. Key .....	10
5.1.5. App .....	11
5.1.6. Temporary Password .....	12
5.1.7. One Time Password (Dynamic Password) .....	12
5.2. Locking Methods .....	13
5.2.1. Deadbolt Locking .....	13
5.2.2. Safety knob .....	13
6. Operations .....	14
6.1. Initial State .....	14
6.2. General Rules of Operations .....	14
6.3. Enter Administrator mode .....	14
6.4. Administrator Settings .....	15
6.4.1. Add Admin .....	15
6.4.2. Modify Admin .....	15
6.4.3. Delete Admin .....	15
6.5. User Settings .....	16
6.5.1. Add User .....	16
6.5.2. Modify User .....	16
6.5.3. Delete User .....	16
6.6. Lock Settings .....	18
6.6.1. Date and Time Setting .....	18
6.6.2. Unlock Mode Setting .....	18

6.6.3.	Passage Mode Setting .....	18
6.6.4.	Alarm Mode Setting.....	18
6.6.5.	Sound Setting .....	19
6.6.6.	Language Setting .....	19
6.6.7.	Unlock Records.....	19
6.6.8.	Storage Query.....	19
6.7.	Factory Reset .....	19
7.	App User Manual .....	20
7.1.	App Download.....	20
7.1.1.	Apple iOS .....	20
7.1.2.	Android.....	20
7.2.	How to connect door lock to App .....	20
7.3.	App Functions .....	21
7.3.1.	Battery Status .....	21
7.3.2.	Remote Dynamic Password / One time password .....	21
7.3.3.	Temporary Password .....	22
7.3.4.	Remote Unlocking via app .....	23
7.3.5.	Records .....	24
8.	Specifications.....	26

# 1. Warning and Safety Instructions

- i. For best performance of the smart lock, it is highly recommended to engage a professional smart lock installer for installation.
- ii. During installation kindly ensure door is opened until installation is completed. This is to avoid any unintentional locking happening.
- iii. Once the door lock is installed successfully, it is recommended to change the initial state administrator password immediately.
- iv. It is advised not to place the mechanical key inside the room in lock. Mechanical key should be kept in a safe place in case of emergency.
- v. For safety purposes, when 5 continuous entry error detected door lock will enter self-protection mode and keyboard panel will freeze for 1 minute.
- vi. Please read this user manual carefully before first use. Keep this manual for further guidance in case.

## 2. Product Layout

Smart lock installation requires heavy duty tools handling. Please engage professionals for proper installation. Our company shall not be liable for any direct or indirect problems, hazards or losses incurred due to improper installation.

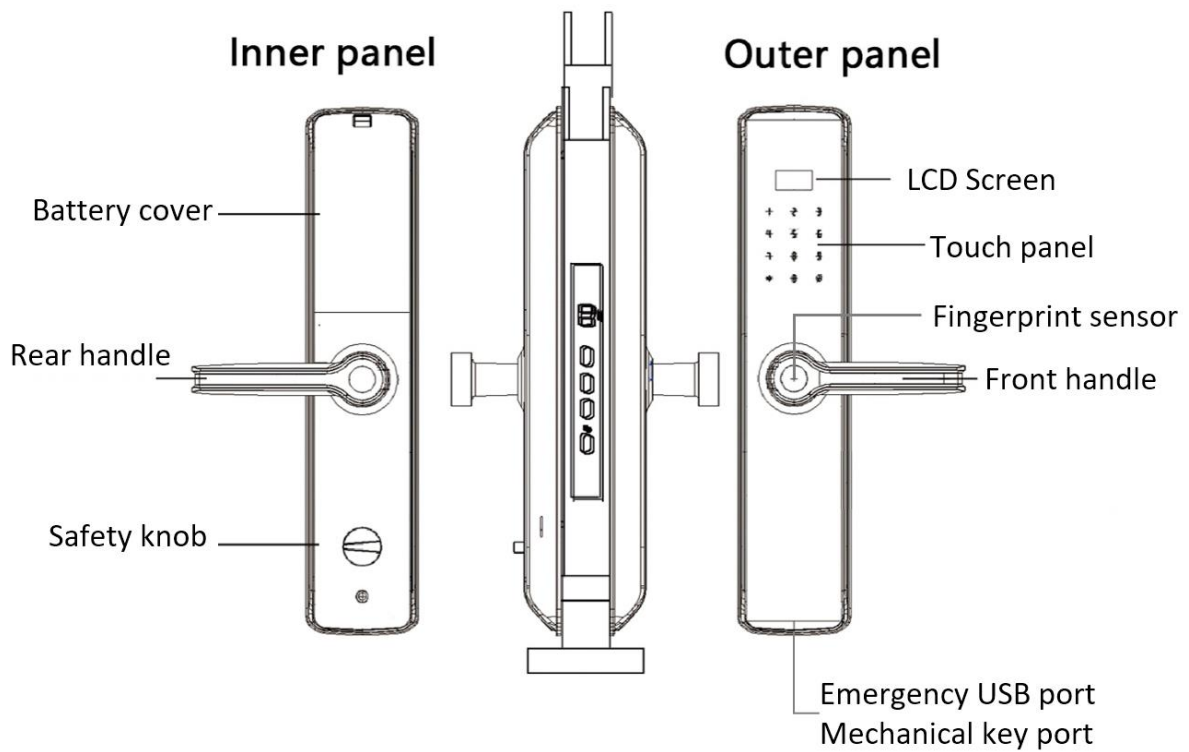

### 3. Components

- i. Front and back lock panels
- ii. Mortise Lock body
- iii. Cylinder lock
- iv. IC Card x 2
- v. Mechanical keys x 2
- vi. AA Batteries x 4

#### 3.1. Accessories List

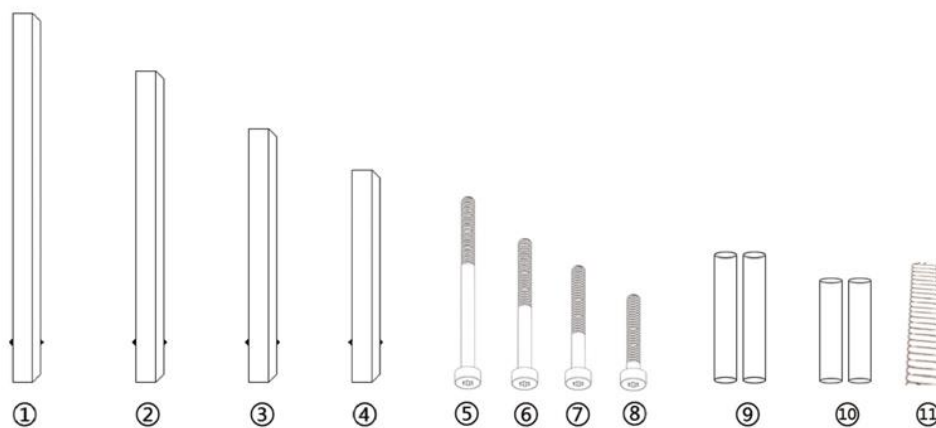

- |                    |                 |                            |
|--------------------|-----------------|----------------------------|
| ① 14 cm square bar | ⑤ 10.5 cm screw | ⑨ 4.5 cm Connecting column |
| ② 12 cm square bar | ⑥ 8.5 cm screw  | ⑩ 3.5 cm Connecting column |
| ③ 10 cm square bar | ⑦ 5.5 cm screw  | ⑪ spring                   |
| ④ 8 cm square bar  | ⑧ 2.5 cm screw  |                            |

#### ACCESSORIES SELECTION METHOD

- ⑧+⑦+④+⑩= 40—55mm Door Thickness
- ⑦+⑥+③+⑨+⑪ = 65—75mm Door Thickness
- ⑥+⑤+①+⑨+⑪ = 95—115mm Door Thickness
- ⑧+⑦+③+⑨+⑪= 55—65mm Door Thickness
- ⑦+⑥+②+⑨+ ⑪= 75—90mm Door Thickness

## 4. Installations

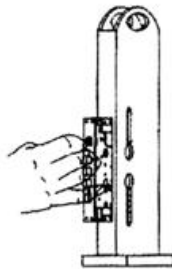

- 4.1** Open the hole on the door according to the opening template and put the lock body into the door frame

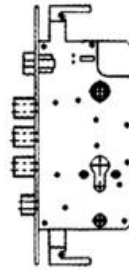

- 4.2** Hook the upper and lower bar when the lock body is inserted (there is no such step when installing the wooden door)

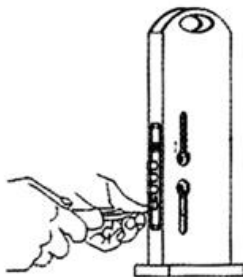

- 4.3** Tighten four set screws on the lock body

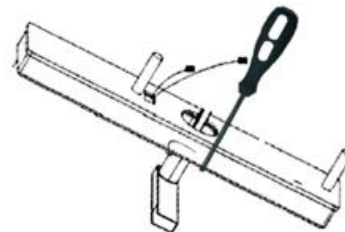

- 4.4** Loosen directional screw that is beside the handle and change handle to the position where the door opens. Tighten it. According to the thickness of the door to choose the appropriate connection column can be installed.

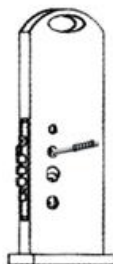

- 4.5** Insert the bar into the lock body, from the outside door to the inside door (put the spring in the handle hole of the inner panel)

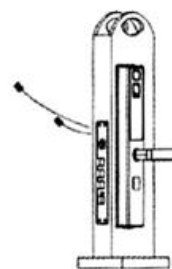

- 4.6** Put a power line of the front panel through the entrance and buckle the front panel

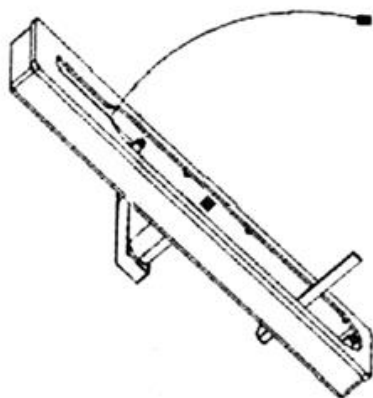

**4.7** Connect the front and rear panel line, put the line into the door, don't press the line

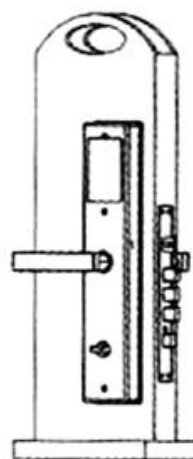

**4.8** Fix the upper and lower screws

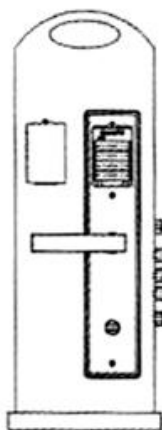

**4.9** Install the battery, cover the battery cover and install the intelligent lock successfully.

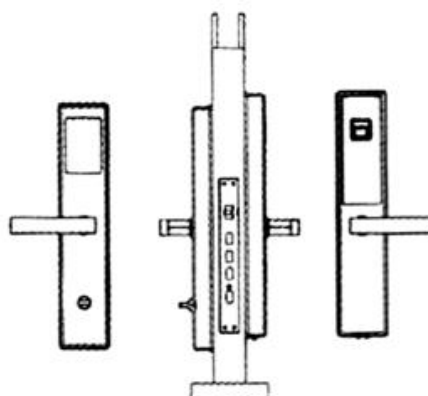

**4.10** Turn internal and external handle, safety knob and mechanical key to check whether all parts are connected well



## 5. Lock Functions

### 5.1. Unlocking Methods

#### 5.1.1. Fingerprint

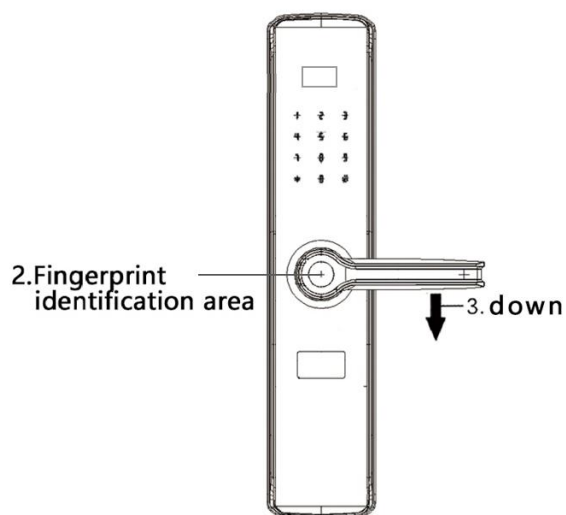

1. Swipe on the keyboard to power the lock.
2. Scan fingerprint at handle identification area.
3. Press handle downward to unlock.

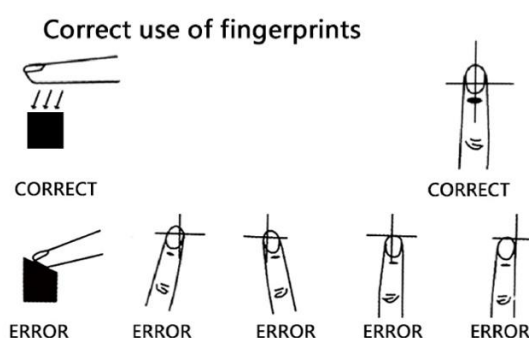

#### 5.1.2. Password

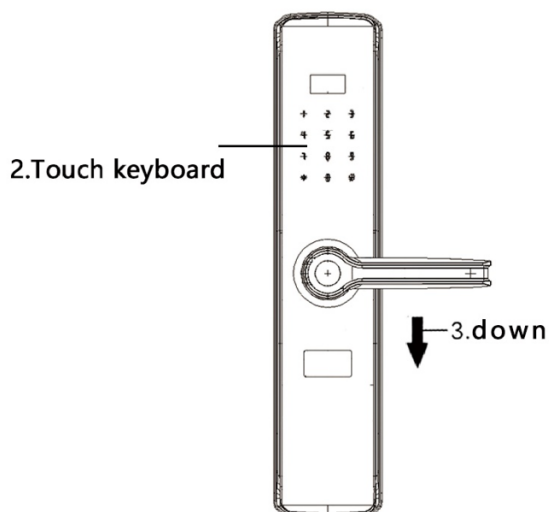

1. Swipe on the keyboard to power the lock.
2. Enter password and press “#” to confirm.
3. Press handle downward to unlock.

##### Anti-peeping function

In case of someone peeping over your password, enter any numbers before and after your passwords.

Your password: 123456

Virtual password: 111111-123456-666666

(Maximum 9 numbers before and after passwords)

### 5.1.3. Card

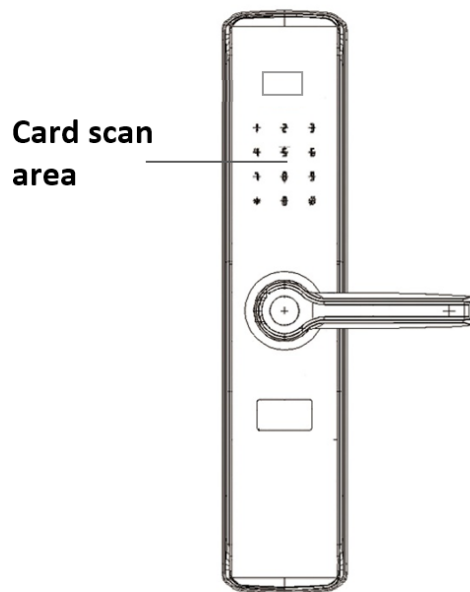

1. Place card near card scan area
2. Press handle downward to unlock

### 5.1.4. Key

If there is an emergency such as forgotten password, the battery is exhausted or the system is not working, you can use the spare mechanical key to unlock.

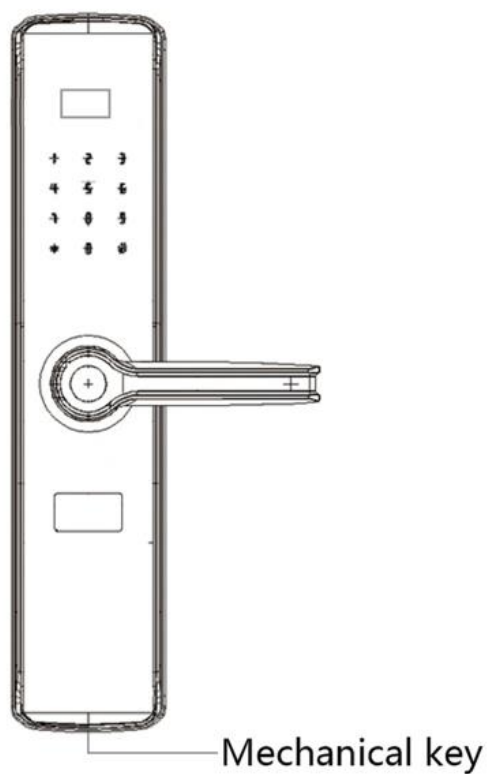

### 5.1.5. App

- i. Press "9" + "#" to activate doorbell function

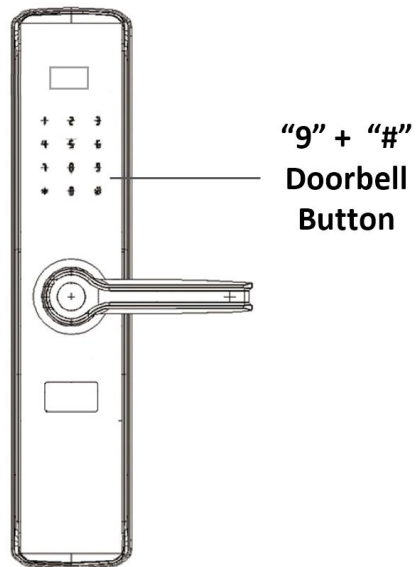

- ii. Receive doorbel call notification on app
- iii. Open app and select smart lock
- iv. Press on "Click open remotely", then press on "Confirm" to allow remote opening

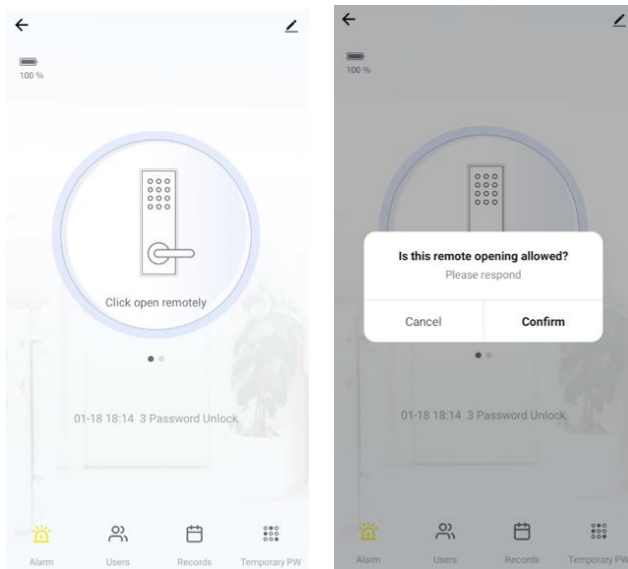

- v. Door unlocked.

### 5.1.6. Temporary Password

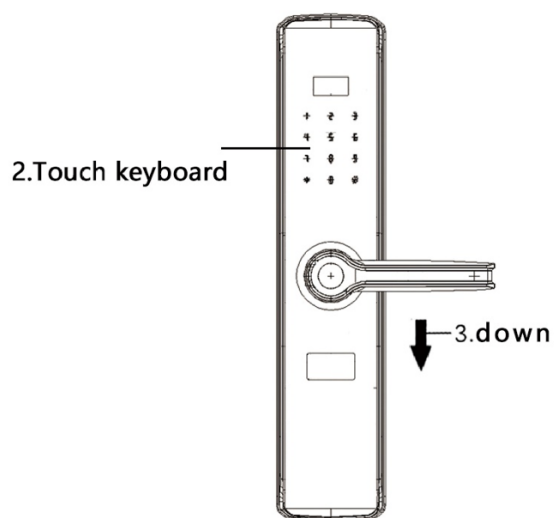

1. Swipe on the keyboard to power the lock.
2. Enter temp password and press “#” to confirm.
3. If failed, please enter “9” + “#” followed by temp password and press “#” to confirm.
4. Press handle downward to unlock.

“9” + “#” is to sync app with smart lock

### 5.1.7. One Time Password (Dynamic Password)

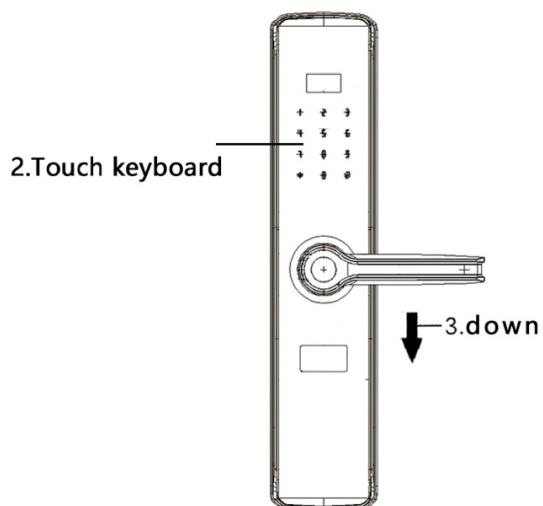

1. Swipe on the keyboard to power the lock.
2. Enter One-time password (Remote Dynamic Password) and press “#” to confirm.
3. If failed, please enter “9” + “#” followed by password and press “#” to confirm.
4. Press handle downward to unlock.

“9” + “#” is to sync app with smart lock

## 5.2. Locking Methods

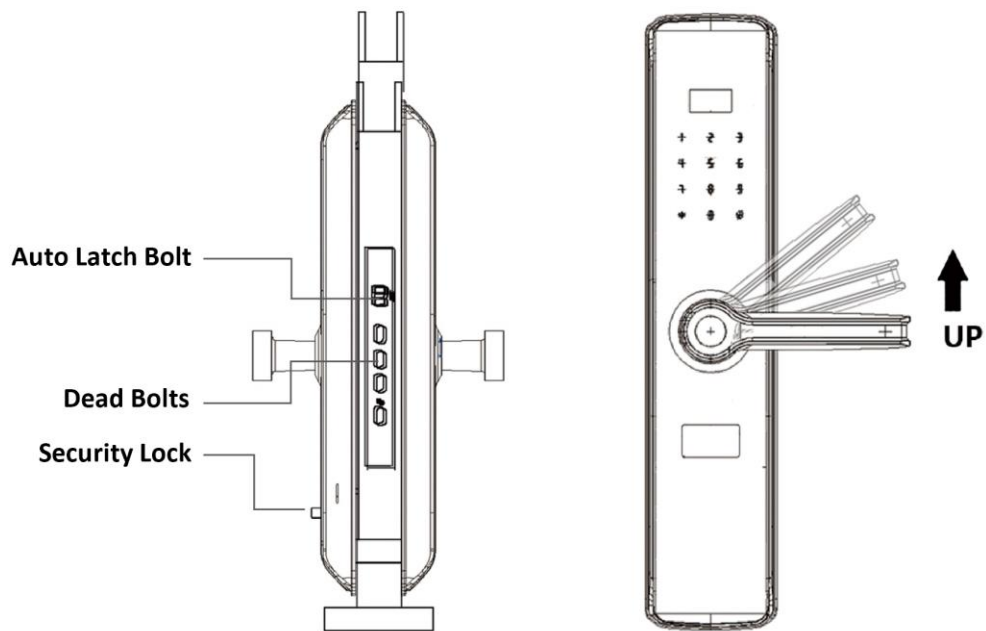

### 5.2.1. Deadbolt Locking

To engage deadbolts locking rotate the internal or external door handle upwards.

### 5.2.2. Safety knob

Security lock at inside panel for internal locking. Once locked, door opening from outside is not allowed.

## 6. Operations

### 6.1. Initial State

- i. In factory initial state default password is "123456" to open the door.
- ii. In factory initial state any fingerprint can open the door.
- iii. After setting administrator information, the initial password "123456" will be deleted automatically.

### 6.2. General Rules of Operations



- i. Press "\*" for clear key or back key. When entering password, click to clear previous input, long press to clear the input.
- ii. Press "#" for confirm key or menu function key
- iii. Press "9" + "#" for Doorbell key
- iv. Swipe panel to activate keypad

### 6.3. Enter Administrator mode

- i. Swipe panel to activate screen
- ii. Enter "\*" + "#"
- iii. Enter Administrator Information (password, fingerprint, or card)
- iv. Enter function management

## 6.4. Administrator Settings

### 6.4.1. Add Admin

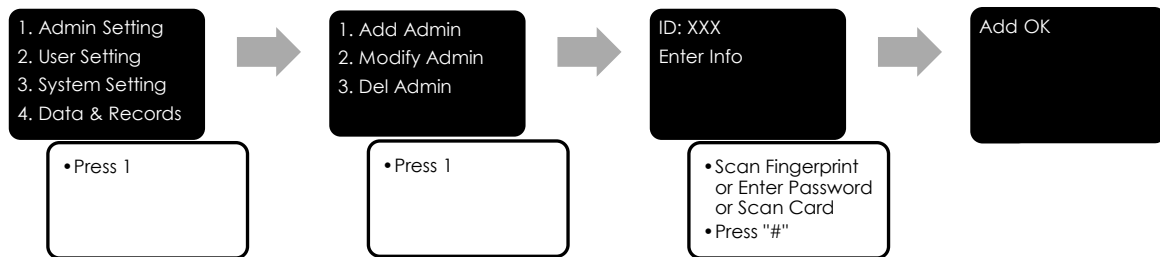

### 6.4.2. Modify Admin

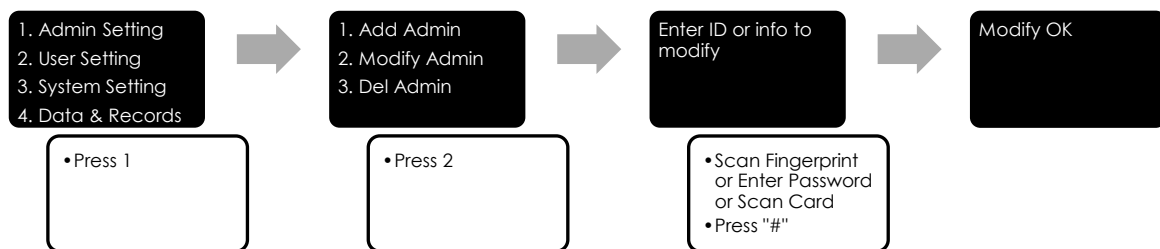

### 6.4.3. Delete Admin

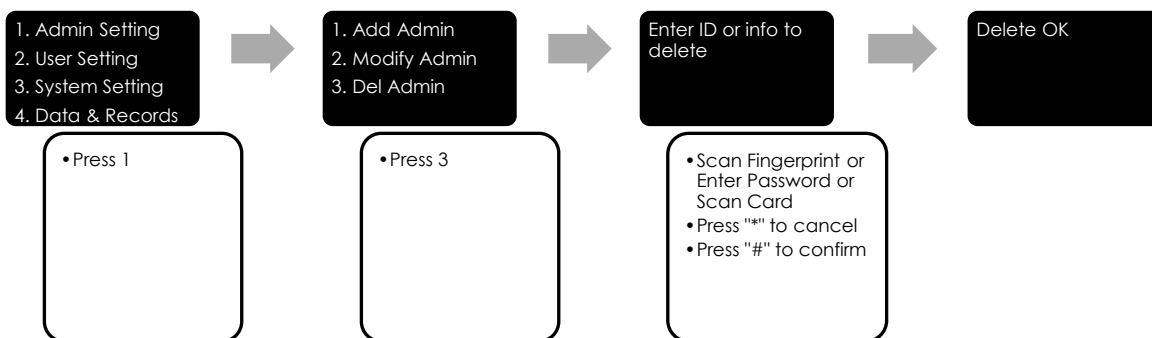

## 6.5. User Settings

### 6.5.1. Add User

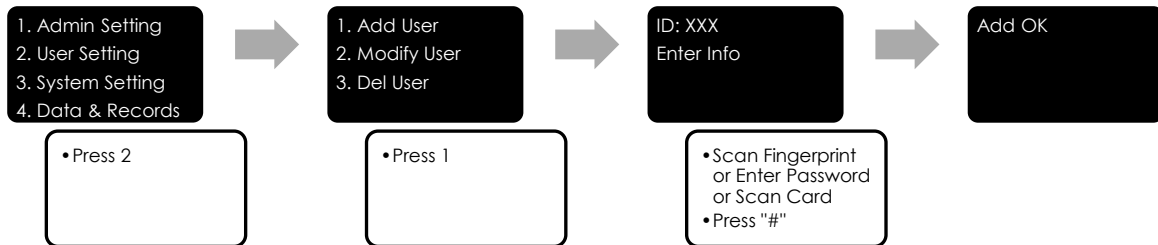

### 6.5.2. Modify User

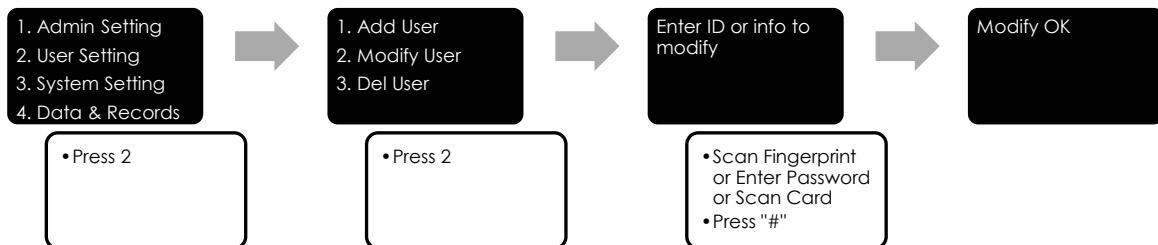

### 6.5.3. Delete User

#### 6.5.3.1. Delete User by ID

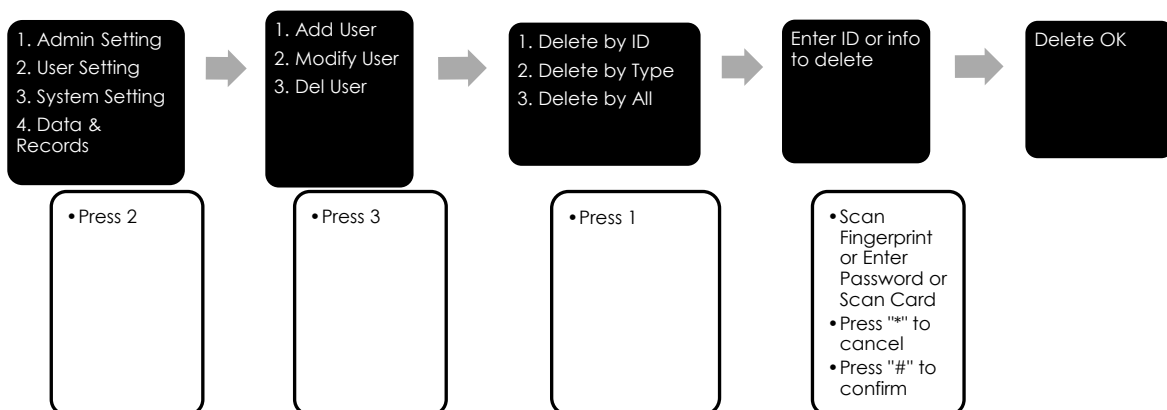



### 6.5.3.2. Delete User by Type

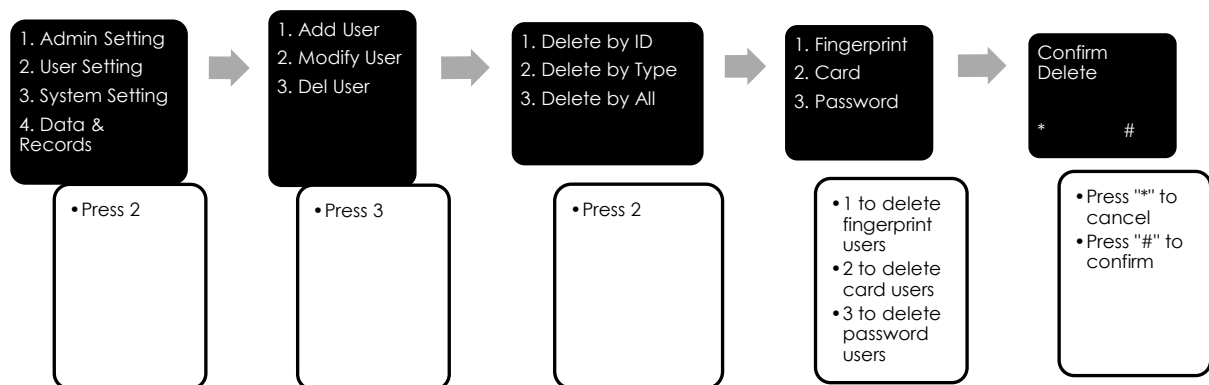

### 6.5.3.3. Delete User by All

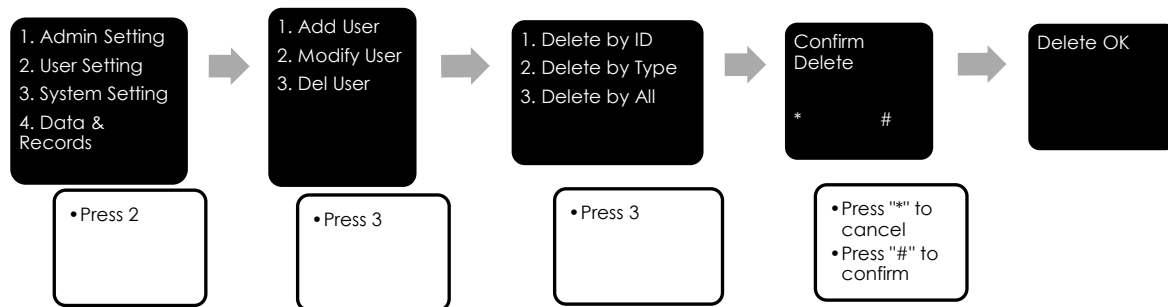

## 6.6. Lock Settings

### 6.6.1. Date and Time Setting

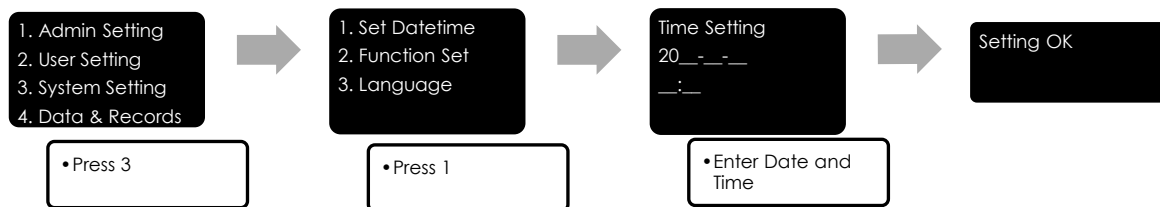

### 6.6.2. Unlock Mode Setting

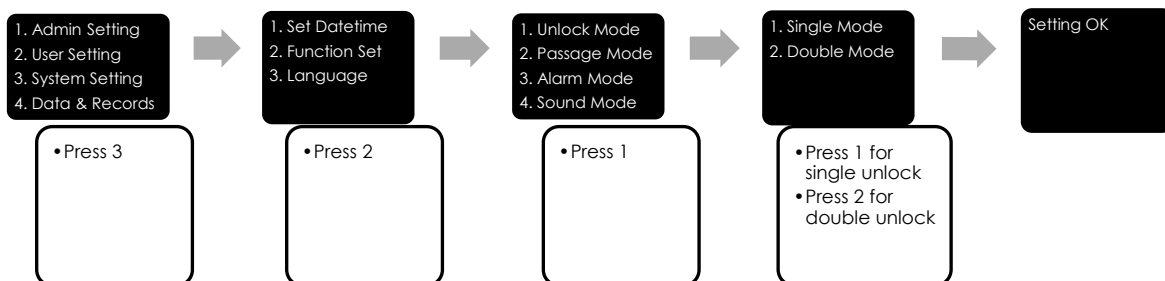

### 6.6.3. Passage Mode Setting

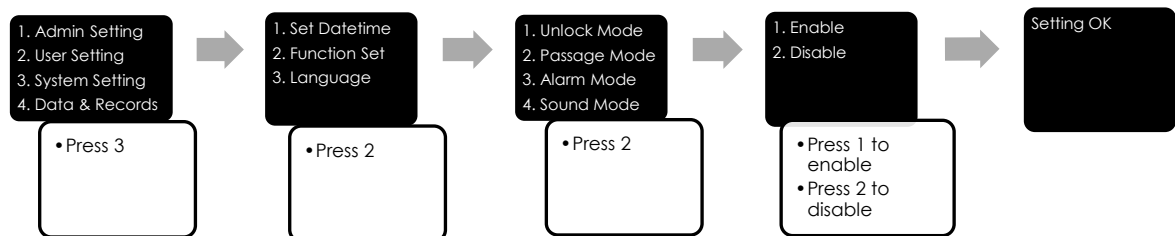

### 6.6.4. Alarm Mode Setting

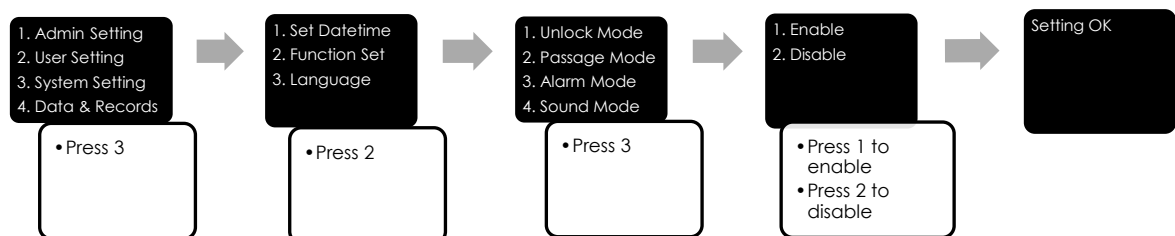

### 6.6.5. Sound Setting

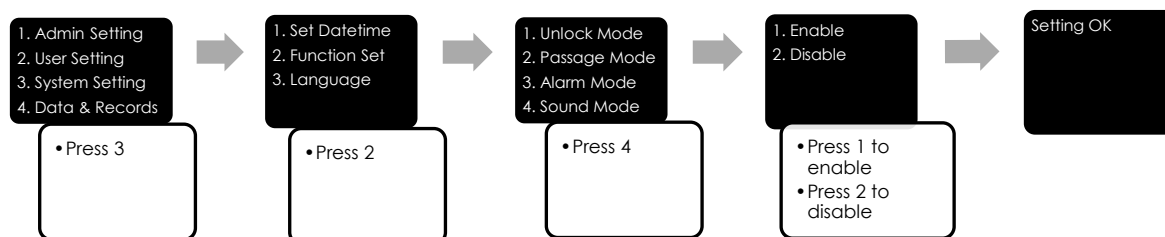

### 6.6.6. Language Setting

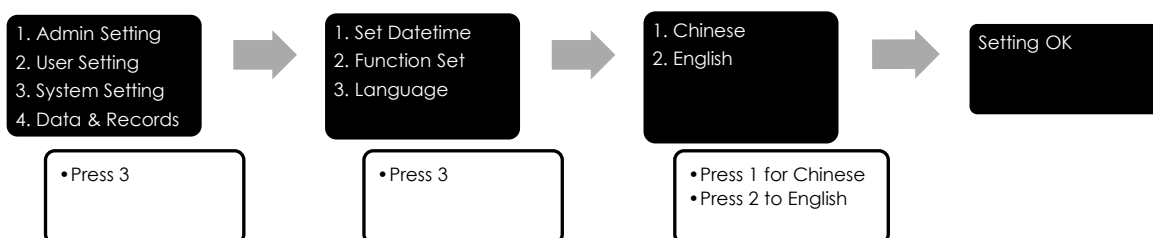

### 6.6.7. Unlock Records

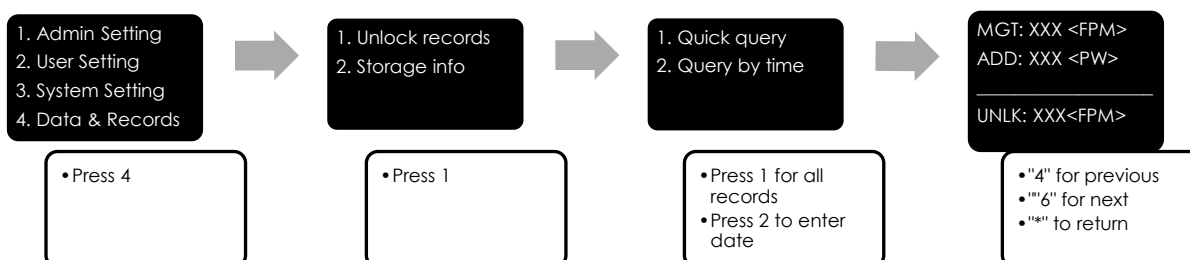

### 6.6.8. Storage Query

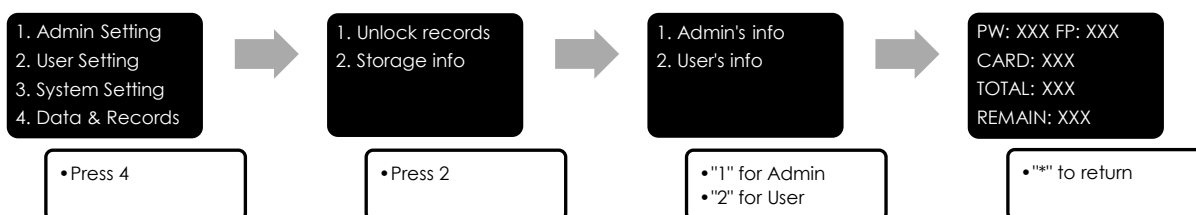

## 6.7. Factory Reset

- Long press the "Reset" button on the back panel for 5 seconds.
- System will enter the state of restored factory settings. All unlock information and record will be cleared.
- Initial password will be "123456" for administrator.

## 7. App User Manual

### 7.1. App Download

#### 7.1.1. Apple iOS



Download the "Smart Life - Smart Living" app at below link and install.

<https://apps.apple.com/us/app/smart-life-smart-living/id1115101477>

#### 7.1.2. Android



Download the app "Smart Life - Smart Living" at below link and install.

<https://play.google.com/store/apps/details?id=com.tuya.smartlife>

### 7.2. How to connect door lock to App

- i. Power on the smart lock by (re)inserting the batteries.
- ii. Long press "Reset" button at the back panel to factory reset the smart lock.
- iii. Press "\*" + "#" and reset Admin information.
- iv. In the app tap the "+" button in the upper right corner to add device
- v. Go to "Security & Video Surveillance" under "Add Manually"
- vi. Tap the "Lock (Wi-Fi)" under "Smart Lock" category.
- vii. Select 2.4GHz WiFi network and enter password. If Wi-Fi is 5GHz, please set it to be 2.4GHz.
- viii. Short press on "Reset" button at the smart lock back panel. You may ignore the password order. Wait for connection.
- ix. Connection successful.

## 7.3. App Functions

### 7.3.1. Battery Status

Battery Status is shown on top left corner of the smart lock control panel.



### 7.3.2. Remote Dynamic Password / One time password

Remote dynamic password / One time password can be generated from app for smart lock opening. This password can only be used once and invalid after 5 minutes.

- i. On the smart lock control panel, swipe to the right of lock icon.

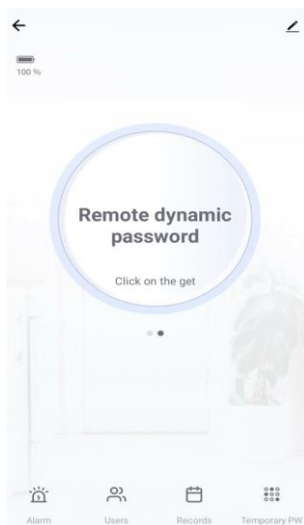

- ii. Click on “Remote dynamic password” to generate one time password

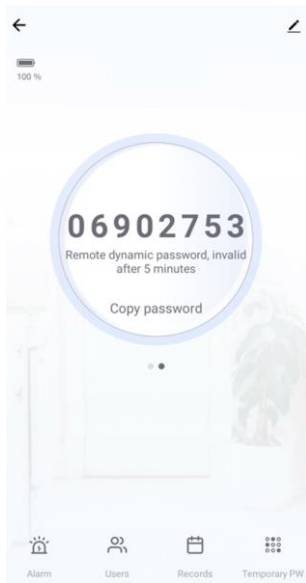

- iii. Copy Password and send to guest.
- iv. Guest to press on “9” + “#” on door lock.
- v. Enter password + “#”. Password will be invalid after 5 minutes or used.
- vi. Door is unlocked. If unattended after 6 seconds, door will be automatically locked.

### 7.3.3. Temporary Password

Temporary password can be set for a certain period. Password will be invalid after the expiration time.

- i. On the smart lock control panel, tap on the “Temporary PW”.
- ii. Tap the button in the upper right corner to create new temporary password.
- iii. Enter password, name, and effective time period.

### 7.3.4. Remote Unlocking via app

- i. Press on “9” + “#” on door lock
- ii. Doorbell call notification received. Open app.
- iii. Press on “Click open remotely”



- iv. Click on “Confirm” to allow remote opening.

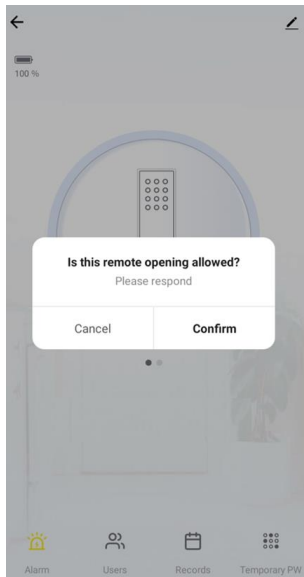

- v. Door unlocked. If unattended after 6 seconds, door will be automatically locked.

### 7.3.5. Records

Alarm records can be checked in the records tab.

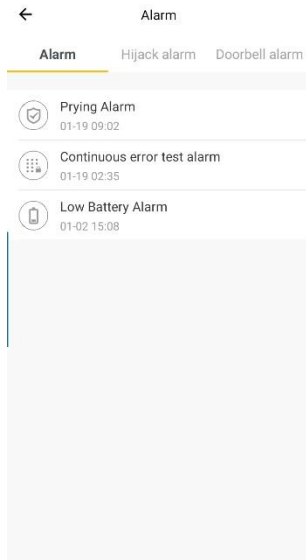

#### 7.3.5.1. Low Battery Alarm

- i. Alarm and phone notification alert when battery is lower than 4.8V.
- ii. Alarm will be activated every time it is opened and can last for 200 times till battery change.
- iii. It is recommended to change battery immediately.

#### 7.3.5.2. Continuous error test alarm

- i. Alarm and phone notification alert when multiple entry failures detected (password, fingerprint, card).
- ii. Smart lock touch panel will be deactivated for 1 minute.

#### 7.3.5.3. Prying Alarm

- i. Alarm and phone notification alert when tampering attempt is detected at smart lock.
- ii. Alarm siren at smart lock will be activated to scare off possible intruders.



### 7.3.5.4. Hijack Alarm

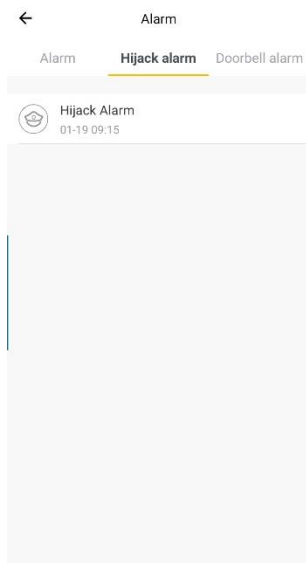

When someone forces you to open the door, you may enter a pre-set hijack unlocking method to send an alarm through the smart door lock.

Set a fingerprint or password for hijack alarm

- i. In the app tap the door lock in the device list to open the device's control panel
- ii. Tap the button in the upper right corner to enter the device editing page
- iii. Tap member management. Associate A with a username and mark A as a hijacking alarm. This helps locate the hijacked person.
- iv. Use A to unlock the door. A hijacking alarm will be sent to the app's Message Centre.

### 7.3.5.5. Doorbell Alarm

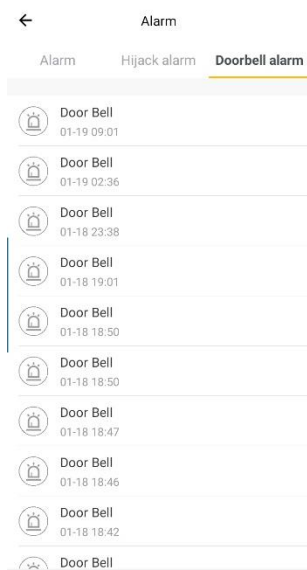

When visitor arrives at doorstep, they can ring the doorbell to notify their arrival.

## 8. Specifications

Parameter	Threshold
Power Supply	4 x AA Batteries
Quiescent Current	<50 $\mu$ A
Working Current	<250 $\mu$ A
Fingerprints	<=100 (9 Admin, 91 Users)
Cards	<=300 (9 Admin, 291 Users)
Passwords	<=300 (9 Admin, 291 Users)
Working Temperature	-10°C ~ 60°C
Working Humidity	20% ~ 93%